

# SWITCH CATALOG



# PUSHBUTTON SWITCHES

## Series - J300

## Alternate Action Moisture Proof Pushbutton Switches

FEATURES	SPECIFICATIONS	CURRENT RATINGS								
		28VDC			120VAC					
		Part Number	Number of Poles	Type of Operation	Resistive Load	Inductive Load	Lamp Load	Resistive Load	Inductive Load <sup>①</sup>	Lamp Load
<ul style="list-style-type: none"> <li>• Alternate action push-push</li> <li>• Moisture proof</li> <li>• Snap action contact design</li> <li>• Seven adapter styles</li> <li>• Four button colors</li> <li>• EMI/RFI version (J334)</li> </ul>	<ul style="list-style-type: none"> <li>• DPDT (J333, J334) and two circuit (J313)</li> <li>• EMI/RFI shielded (J334P6)</li> <li>• Seal level 2 per MIL-PRF-8805</li> <li>• Operating force: 2.75 ± 1 lb (12 IN. ± 4.4N)</li> <li>• Electrical life: 25,000 operations minimum</li> <li>• Operating temperature: -40°F to +185°F (-40°C to +85°C)</li> <li>• Total plunger travel: 0.200 in. (5.1mm) approx.</li> <li>• Weight (approx.): 0.035 lbs (15.9g)</li> <li>• Available in number 6 button style only</li> </ul>	J313	1	Alternate	10	5	1	10	5	1
		J333	2	Alternate	1	—	1	1	—	1
		J334 <sup>②</sup>	2	Alternate	1	—	—	—	1	—

① p.f.=.75  
② EMI/RFI shielded

### ORDERING INFORMATION

**J 3 1 3 W 6**

BUTTON STYLE  
CLEAR "W" ADAPTER  
2 CIR. SWITCH TYPE

**J 3 3 4 P 6 R**

RED BUTTON  
DPDT EMI/RFI SHIELDED SWITCH

**J 3 3 3 P B 6 R**

RED BUTTON  
BUTTON STYLE  
BLACK "P" ADAPTER  
DPDT SWITCH TYPE

### SPECIFY ADAPTER

- Seven Adapter Styles  
Specify Black: B, Clear: No letter
- Plunger Color, Specify:  
Black: No letter  
Red: R  
White: W  
Gray: GY
- DPDT J333 and Two Circuit J313
- J334 only available as J334P6 or J334P6R

### ADAPTER STYLES

TYPE HA

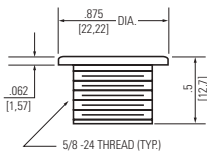

TYPE M

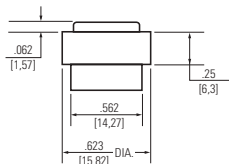

TYPE N

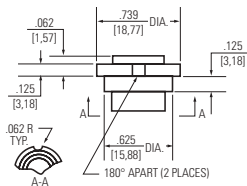

TYPE P

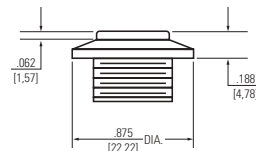

TYPE PA

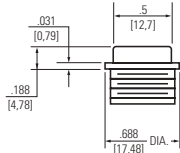

TYPE W

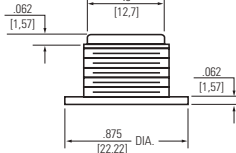

TYPE Y

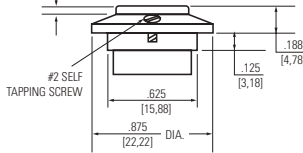

**STANDARD**  
0.00 = inches  
[0,0] = mm

Dimensions for reference only.

# Series - J300

# PUSHBUTTON SWITCHES Alternate Action Moisture Proof Pushbutton Switches

## DIMENSIONS - J300

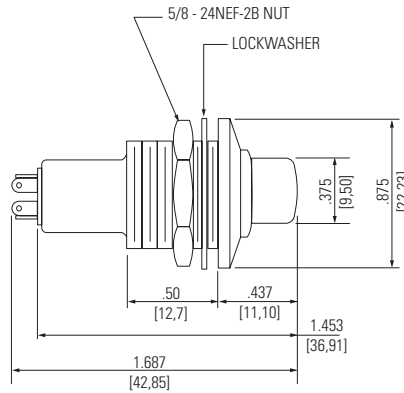

## SCHEMATIC DIAGRAMS

### J313 TYPE

### J333 AND J334 TYPE



J300

#### TWO CIRCUIT

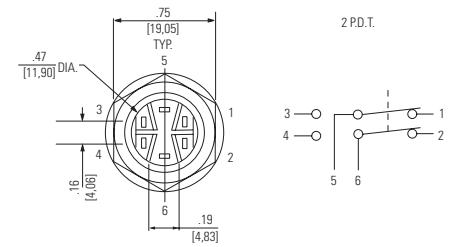
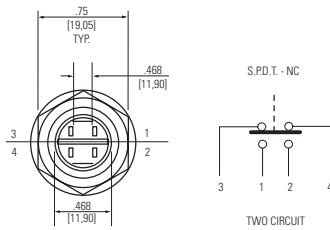

## "W" J334P6 - EMI/RFI SHIELDING

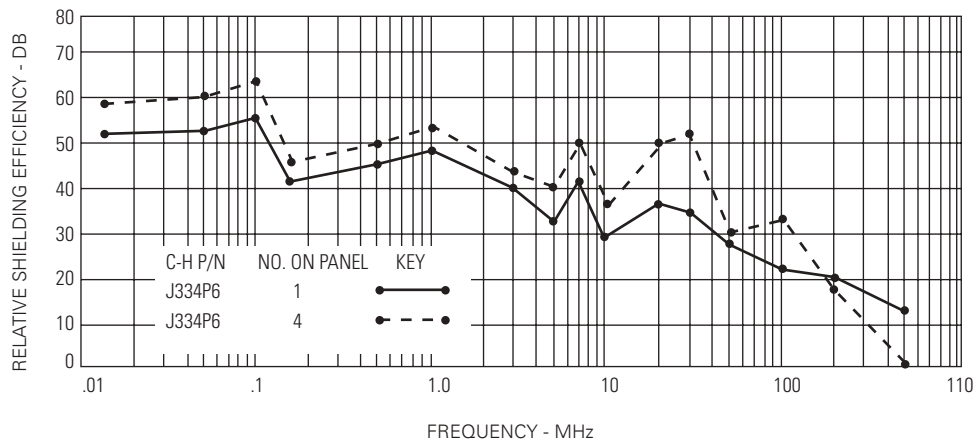

Graphic illustration defines relative shielding efficiency of RFI shielded component/ components over unshielded device.

### STANDARD

0.00 = inches

[0,0] = mm

Mounting dimensions for reference only.